

VWXL Series

Vapourtight

Page 1 of 2

Features

- 4" Box-Mounted Wall Brackets
- Vapourtight, fully enclosed and gasketed. Rugged design for locations exposed to moisture, corrosive fumes, non-explosive vapours or non-combustible dusts. All exposed metal parts are weatherproof, corrosion resistant, surface hardened, die-cast aluminum.
- Glazed porcelain, pre-wired socket, enclosed with screw on heat resistant clear glass globe.
- Mounting to be globe down only.
- Not suitable for hazardous locations.
- Comes with 1 year limited warranty.

Available up to 200W Incandescent
(Lamp Not Included)



Dimensions

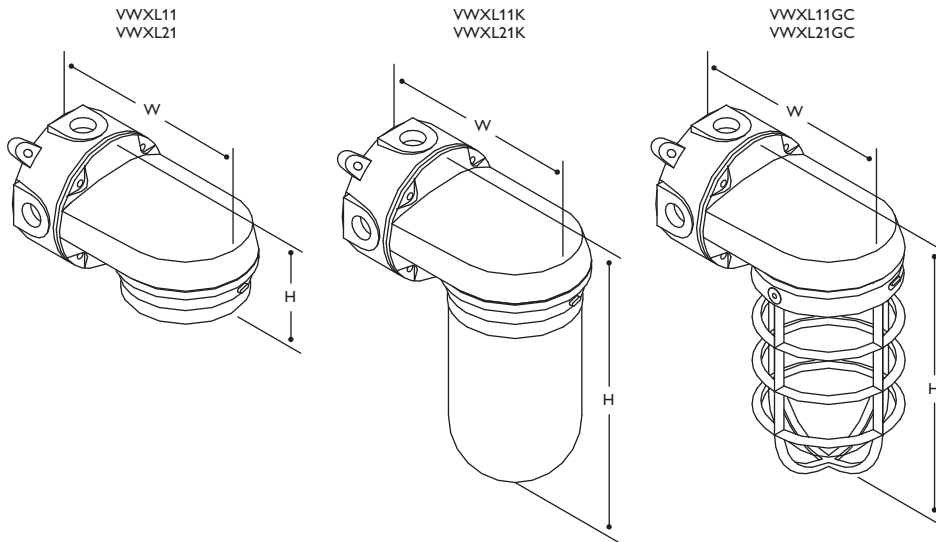

VWXL11GC
VWXL21GC

Job Information

Type:

Job Name:

Cat. No.:

Lamp(s):

Notes:

VWXL Series

Vapourtight

Page 2 of 2

Ordering information

Catalogue Number	Maximum Wattage	Description	Height (H)	Width (W)
VWXL11	100W	Surface unit only. Order globe separately	4" [102mm]	6-3/8" [162mm]
VWXL21	200W	Surface unit only. Order globe separately	4" [102mm]	7-5/8" [194mm]
VWXL11K	100W	With Clear Glass Globe	9-1/4" [235mm]	6-15/16" [176mm]
VWXL21K	200W	With Clear Glass Globe	10-7/8" [276mm]	7-7/16" [189mm]
VWXL11GC	100W	With Clear Glass Globe, Cast Guard	9-5/16" [237mm]	7-7/16" [189mm]
VWXL21GC	200W	With Clear Glass Globe, Cast Guard	11-3/8" [289mm]	7-3/4" [197mm]

- Complete with Vapourtight die-cast aluminum box. Four side and one top hole tapped 1/2" NPT.
- Three plugs included.
- For 3/4" conduit, use VW series with VXL-13 universal box.

Job Information

Type:



© 2013 Koninklijke Philips N.V. (Royal Philips). All rights reserved.
Specifications are subject to change without notice.
www.philips.com/luminaires

SD0029 05/13

Philips Lighting Company
200 Franklin Square Drive
Somerset, NJ 08873
Phone: 855-486-2216

Philips Lighting Company
281 Hillmount Road
Markham ON, Canada L6C 2S3
Phone: 800-668-9008