

Vero Handrinse basin ground # 0704450027

| < 17 3/4" Inch > |

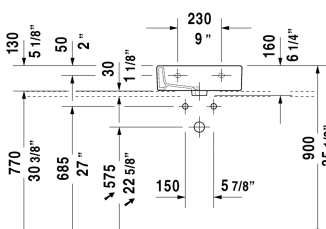
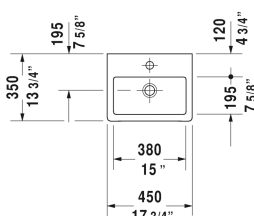

Handrinse basin ground	Dimension	Weight	Order number
with overflow, with faucet deck, wall-mounted, hardware included, cUPC® listed*, 17 3/4" Inch			
Colors			
00 White			
Variant			
●	17 3/4" x 13 3/4" Inch	25.4 lb	0704450027
Infobox			
* Complies with following standards: ASME A112.19.2/CSA B45.1			
Sanitary ceramics with the special WonderGliss surface finish will remain clean and attractive-looking for a long time to come. When ordering WonderGliss please add a "1" as eleventh digit to the model number.			
Space-saving siphon	1 1/4" Inch	0.9 lb	005076
Design Siphon		3.3 lb	005036

All drawings contain the necessary measurements which are subject to standard tolerances. They are stated in inch & mm and are non-binding. Exact measurements, in particular for customized installation scenarios, can only be taken from the finished ceramic piece.