

# 2400D SERIES™ RACEWAY

## 5507 Series Faceplates Ordering Information (continued)

### Single Receptacle Faceplate

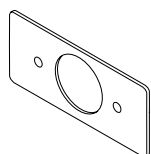

**PART NUMBERS:**  
**5507T2** (Ivory)  
**5507T2-FW** (Fog White)

Covers single receptacles 1.41" (35.8mm) diameter.

### Extron® AAP Faceplate

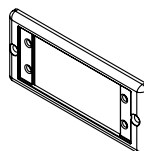

**PART NUMBERS:**  
**5507AAP** (Ivory)  
**5507AAP-FW** (Fog White)  
**5507AAP-WH** (White)  
**5507AAP-G** (Gray)  
**5507AAP-BK** (Black)

Metal faceplate for use with two Extron® Electronics AAP single space modules.

### Dual RJ11/RJ45 Connector Faceplate

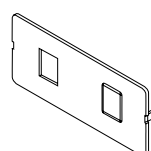

**PART NUMBERS:**  
**5507RJ** (Ivory)  
**507RJ-FW** (Fog White)

Accepts one or two keystone device modules. Has one keystone opening and a KO for the other.

### 5507MAAP Extron® MAAP Faceplate

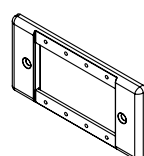

**PART NUMBERS:**  
**5507MAAP** (Ivory)  
**5507MAAP-FW** (Fog White)  
**5507MAAP-WH** (White)  
**5507MAAP-G** (Gray),  
**5507MAAP-BK** (Black)

Metal faceplate for use with four Extron® Electronics MAAP single space modules.

### Flush Dual RJ11/RJ45 Connector Faceplate

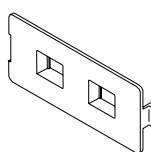

**PART NUMBERS:**  
**5507FRJ** (Ivory)  
**5507FRJ-FW** (Fog White)

Accepts one or two keystone device modules, recessed to provide a flush installation. Has one keystone opening and a KO for the other.

### End Plates

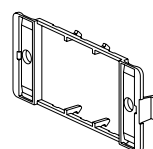

**PART NUMBERS:**  
**CM-EPLA** (Ivory)  
**CM-EPLA-FW** (Fog White)

Mounts Wiremold CM2 series communication modules into 5507 opening. Includes two outlet identification labels with clear covers and two matching screw covers.

### Ortronics® Faceplate

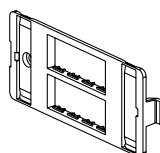

**PART NUMBERS:**  
**5507-4TJ** (Ivory)  
**5507-4TJFW** (Fog White)

Accepts four Ortronics® TracJack Devices.

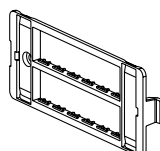

**PART NUMBERS:**  
**5507-6TJ** (Ivory)  
**5507-6TJFW** (Fog White)

Accepts six Ortronics® TracJack Devices.

### End Plates

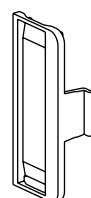

**PART NUMBERS:**  
**S2-EPL** (Ivory)  
**S2-EPL-FW** (Fog White)

Mounts Ortronics® Series II modules into 5507 opening. Includes two outlet identification labels with clear covers and two matching screw covers.