

THE SHARKBITE® CONNECTION SYSTEM

SharkBite® Push-Fit Products

SharkBite continues to lead the industry with an expansive line of fittings, valves and other innovative, labor saving products for plumbing projects. SharkBite push-fit fittings are the fastest, easiest way to join copper, CTS CPVC and PEX in any combination. With no soldering or glue. Certified: 200 psi & 200° F (93° C). Use for new installation and repair of potable water distribution systems. See certifications & approvals on page 12.

Couplings

Straight Couplings



SIZE	P/N	P/N (Lead Free)
1/4" X 1/4"	U004	U004LF
3/8" X 3/8"	U006	–
1/2" X 1/2"	U008	U008LF
5/8" X 5/8"	U012	–
3/4" X 3/4"	U016	U016LF
1" X 1"	U020	U020LF

Reducing Couplings



3/8" X 1/2"	U009	U009LF
3/4" X 5/8"	U057	–
3/4" X 1/2"	U058	U058LF
1" X 3/4"	U060	U060LF

Connectors

Straight Connectors



1/2" X 1/2" FNPT	U072	U072LF
3/4" X 3/4" FNPT	U088	U088LF
1" X 1" FNPT	U094	U094LF
1/2" X 1/2" MNPT	U120	U120LF
3/4" X 3/4" MNPT	U134	U134LF
1" X 1" MNPT	U140	U140LF

Bullnose Connectors

3/4" X 1/2" FNPT	U092	–
3/4" X 1/2" MNPT	U138	U138LF

Reducing Connectors



1/4" X 1/2" FNPT	U066	U066LF
1/2" X 3/4" FNPT	U068	U068LF
3/8" X 1/2" FNPT	U070	–
1/4" X 1/2" MNPT	U110	U110LF
1/2" X 3/4" MNPT	U116	U116LF
3/8" X 1/2" MNPT	U118	–
5/8" X 3/4" MNPT	U126	–
3/4" X 1" MNPT	U139	–
1" X 3/4" MNPT	U142	U142LF

Elbows



SIZE	P/N	P/N (Lead Free)
1/4" X 1/4"	U244	U244LF
3/8" X 3/8"	U246	–
1/2" X 1/2"	U248	U248LF
5/8" X 5/8"	U252	–
3/4" X 3/4"	U256	U256LF
1" X 1"	U260	U260LF
1/2" X 1/2" MNPT	U280	U280LF
1/2" X 1/2" FNPT	U308	U308LF

Reducing Elbow



1/2" X 3/8"	U272	–
3/4" X 5/8"	U273	–
3/4" X 1/2"	U274	U274LF
1" X 3/4"	U278	–

Dishwasher Elbow

1/4" X 3/8" MIP	U276	U276LF
1/2" X 3/8" MNPT	U281	–

Drop Ear Elbows



1/2" X 1/2"	U249	U249LF
3/8" X 1/2" FNPT	U332	–
1/2" X 1/2" FNPT	U334	U334LF
3/4" X 3/4" FNPT	U340	–

Hy-Ear Elbow



1/2" X 1/2" FNPT	U335	U335LF
------------------	------	--------

Tees



1/4" X 1/4" X 1/4"	U358	U358LF
3/8" X 3/8" X 3/8"	U360	–
1/2" X 1/2" X 1/2"	U362	U362LF
5/8" X 5/8" X 5/8"	U366	–
3/4" X 3/4" X 3/4"	U370	U370LF
3/4" X 3/4" X 3/4" FNPT	U462	–
1" X 1" X 1"	U374	U374LF
1" X 1" X 1" FNPT	U464	–

Bullnose Tee



3/8" X 3/8" X 1/2"	U364	–
--------------------	------	---

Reducing Tee



1/2" X 1/2" X 1/4"	U359	–
1/2" X 1/2" X 3/8"	U363	–
3/4" X 3/4" X 1/2"	U412	U412LF
3/4" X 1/2" X 3/4"	U444	U444LF
3/4" X 1/2" X 1/2"	U454	U454LF
1" X 1" X 3/4"	U416	U416LF

CERTIFICATIONS

The **SharkBite**® push-fit fittings have been design certified and listed to ASSE 1061/NSF 61. The **SharkBite**® push-fit fittings are listed by IAPMO and are certified for potable and hydronic heating water distribution (note: Glycol mixture for hydronics is not to exceed 50% concentration). The **SharkBite**® push-fit fittings have been certified for underground applications and as a manufactured joint without access panels and they meet UPC, IPC and cUPC requirements.

Please consult with local plumbing codes concerning specific applications.

The **SharkBite**® tubing without oxygen barrier is approved for all model codes in the US and Canada for use in hydronic and potable water systems and is certified to the following standards: NSF 14/61, NSF P171, ASTM F 876, ASTM F 877, CSA B137.5 and AWWA C904.

The **SharkBite**® tubing with oxygen barrier is approved for use in all model codes in the US and Canada for use in hydronic and potable water systems and is certified to the following standards: NSF 14/61, NSF P171, ASTM F 876, ASTM F 877, CSA B137.5 and AWWA C904.

Note: The **SharkBite**® push-fit fittings are not approved for use with chrome-plated pipe.

SHARKBITE® PEX INSIDE (ID) AND OUTSIDE DIAMETER (OD)

Nominal Diameter	OD inches	ID inches
1/4"	0.375	0.305
3/8"	0.500	0.350
1/2"	0.625	0.475
5/8"	0.750	0.652
3/4"	0.875	0.671
1"	1.125	0.885



OVERBUILT IS AN UNDERSTATEMENT.®

2400 7th Avenue SW
Cullman, AL 35055-0278
1-877-700-4242
FAX: 1-877-700-4280
www.cashacme.com

In Canada Contact:

1-888-820-0120
FAX: 1-888-820-0121
www.cashacme.ca



A Division of the Reliance Worldwide Corporation

SharkBite® Push-Fit Fittings

For Copper, CPVC or PEX Pipe

DESCRIPTION

The SharkBite® push-fit fittings allow the user to connect pipe in seconds with relative ease.

FEATURES AND BENEFITS

Instant push-fit connection for increased ease-of-use:

No soldering, clamps, unions, or glue required.

Fittings certified to 200 PSI and 200°F (93°C):

Proven durability and quality.

Fits copper tubing, and CTS CPVC and PEX:

Connects all three types in any combination.

Integral tube liner for PEX installations:

Integrated design means no loose components, ensures secure, reliable connection.

Design certified and agency listed:

Inspector friendly, peace of mind!

Compact, robust DZR brass body:

Foundation of a strong, corrosion resistant, durable fitting.

Design certified to ANSI/NSF-61 and ASSE 1061 product standard for use in potable water and hydronic heating water distribution:

Quality engineered and manufactured.

Approved to be used underground and behind walls without access panels.

Designed for hydronic heating as well as potable water distribution.

SPECIFICATION

The tube shall be inserted into the **SharkBite® push-fit fitting** in the first stage through a release collar and then through a stainless steel grab ring. The grab ring has teeth that open out and grip onto the tube. At the second stage the tube shall be pushed through an O-ring protector which aligns the tube. A specially formulated EPDM O-ring shall be compressed between the wall of the fitting and the tube before the end of the tube reaches the tube stop. Only when the tube has passed through the O-ring and reached the tube stop shall a secure joint be created. The fitting shall be a **SharkBite® push-fit fitting**.

TYPICAL INSTALLATION

Connecting a joint:

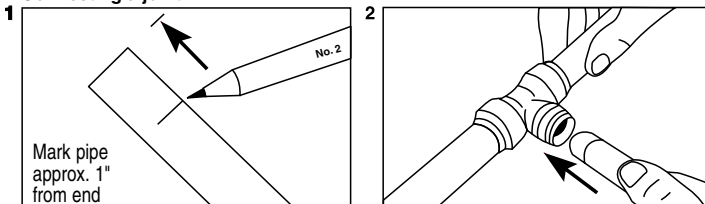

Push the pipe and fitting together firmly with a twisting action until it clicks.

Allow at least 1" clearance between fittings for disconnection.

(Please consult with local plumbing codes concerning specific water heater piping requirements.)

Disconnecting a joint:

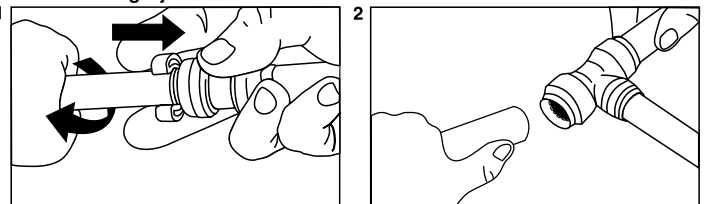

Push the disconnect clip against the release collar and pull the pipe with a twisting action.

SPECIFICATION DATA

Performance:

Maximum working pressure200 psi

Maximum temperature200°F (93°C)

ServicePotable water

Materials:

BodyDZR brass

O-ringEPDM

Grab ringStainless steel

Tube support linerPolysulfone

Finish:

Natural Brass or Chrome Plated

CERTIFICATIONS

The **SharkBite® push-fit fittings** have been design certified and listed to **ASSE 1061/NSF 61**. The **SharkBite® push-fit fittings** are listed by **IAPMO** and are certified for potable and hydronic heating water distribution (note: Glycol mixture for hydronics is not to exceed 50% concentration). The **SharkBite® push-fit fittings** have been certified for underground applications and as a manufactured joint without access panels and they meet **UPC, IPC** and **cUPC** requirements.

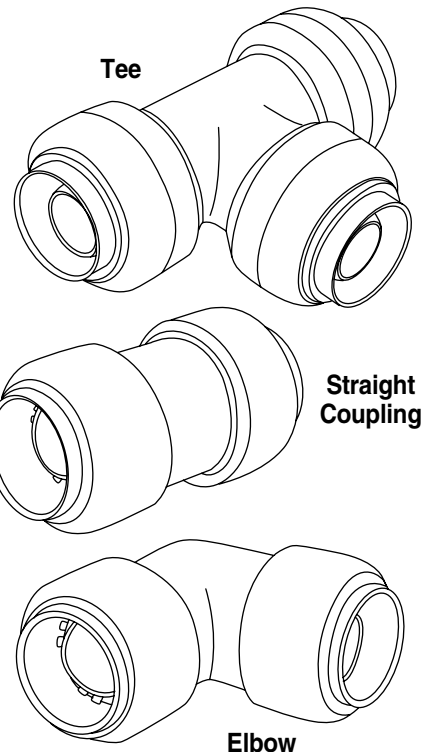

SharkBite® Push-Fit Fittings

For Copper, CPVC or PEX Pipe

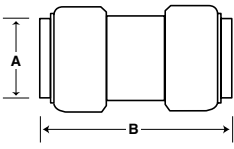

Straight Coupling Dimensions

P/N	A	B
U004	1/4"	1.59"
U006	3/8"	1.84"
U008	1/2"	2"
U016	3/4"	2.36"
U020	1"	2.72"

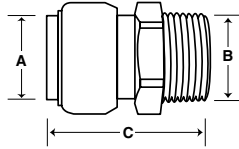
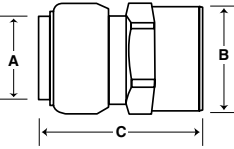

Connector Dimensions

P/N	A	B	C
U066	1/4"	1/2" FNPT	1.61"
U068	1/2"	3/4" FNPT	1.75"
U070	3/8"	1/2" FNPT	1.73"
U072	1/2"	1/2" FNPT	1.64"
U092	3/4"	1/2" FNPT	1.83"
U088	3/4"	3/4" FNPT	1.88"
U094	1"	1" FNPT	2.17"
U110	1/4"	1/2" MNPT	1.64"
U118	3/8"	1/2" MNPT	1.77"
U120	1/2"	1/2" MNPT	1.64"
U116	1/2"	3/4" MNPT	1.75"
U134	3/4"	3/4" MNPT	1.89"
U138	3/4"	1/2" MNPT	1.90"
U140	1"	1" MNPT	2.48"
U142	1"	3/4" MNPT	2.11"

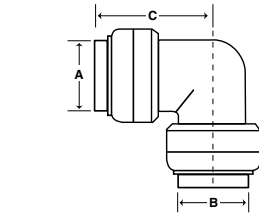

Elbow Dimensions

P/N	A	B	C
U244	1/4"	1/4"	1.16"
U276	1/4"	3/8" MIP	1.16"
U246	3/8"	3/8"	1.28"
U272	1/2"	3/8"	1.43"
U248	1/2"	1/2"	1.36"
U256	3/4"	3/4"	1.64"
U260	1"	1"	1.933"
U274	3/4"	1/2"	1.373"
U280	1/2"	1/2" MNPT	1.21"
U308	1/2"	1/2" FNPT	1.21"

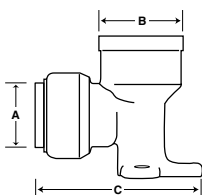

Drop Ear Elbow Dimensions

P/N	A	B	C
U249	1/2"	1/2"	2.20"
U332	3/8"	1/2" FNPT	1.83"
U334	1/2"	1/2" FNPT	1.77"
U335*	1/2"	1/2" FNPT	2.0"
U340	3/4"	3/4" FNPT	2.5"

*Hy-Ear Elbow

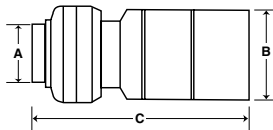

Fitting Reducer Dimensions

P/N	A	B	C
U719	3/8"	1/2"	2.08"
U721	3/8"	3/4"	2.27"
U722	1/2"	1"	3"
U724	3/4"	1"	2.5"

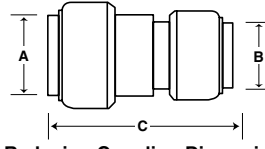

Reducing Coupling Dimensions

P/N	A	B	C
U009	3/8"	1/2"	2.0"
U058	3/4"	1/2"	2.2"
U060	1"	3/4"	2.51"

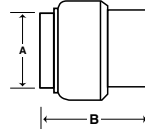

End Stop Dimensions

P/N	A	B
U512	3/8"	1.11"
U514	1/2"	1.08"
U518	3/4"	1.32"
U520	1"	1.52"

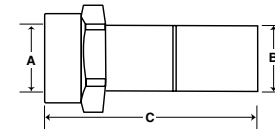

Fitting Adapter Dimensions

P/N	A	B	C
U766	3/4" FNPT	3/4"	2.83"
U772	1" FNPT	1"	2.83"

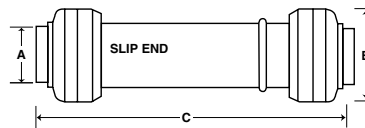

Slip Coupling* Dimensions

P/N	A	B	C
U3008	1/2"	1.075"	4.46"
U3016	3/4"	1.355"	4.42"
U3020	1"	1.64"	4.5"

*For use with copper only.

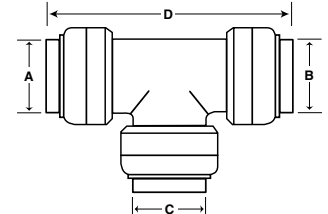

Tee Dimensions

P/N	A	B	C	D
U358	1/4"	1/4"	1/4"	2.30"
U360	3/8"	3/8"	3/8"	2.77"
U362	1/2"	1/2"	1/2"	2.72"
U363	1/2"	1/2"	3/8"	2.85"
U364	3/8"	3/8"	1/2"	2.77"
U370	3/4"	3/4"	3/4"	3.24"
U374	1"	1"	1"	3.84"
U412	3/4"	3/4"	1/2"	3.04"
U416	1"	1"	3/4"	3.63"
U444	3/4"	1/2"	3/4"	3.08"
U454	3/4"	1/2"	1/2"	2.92"

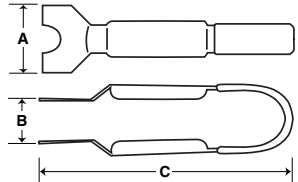

Disconnect Tong Dimensions

P/N	Fits SharkBite	A	B	C
U711	1/2"	1.7"	2"	6.5"
U713	3/4"	1.7"	2"	6.5"
U715	1"	1.7"	2"	6.5"

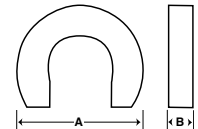

Disconnect Clip Dimensions

P/N	Size	A	B
U706	1/4"	1.19"	0.3"
U708	3/8"	1.22"	0.3"
U710	1/2"	1.22"	0.3"
U712	3/4"	1.72"	0.4"
U714	1"	2"	0.4"

Note: Disconnect Clips sold separately

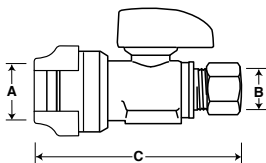

Straight Stop (Chrome Plated) Dimensions

P/N	A	B	C
23037-0000	1/2"	3/8" compression	2.68"

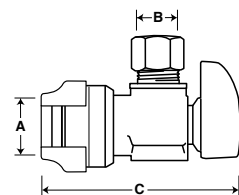

Angle Stop (Chrome Plated) Dimensions

P/N	A	B	C
23036-0000	1/2"	3/8" compression	2.58"

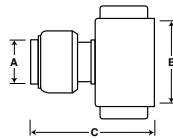

Ballcock Connector Dimensions (Chrome Plated)

P/N	A	B	C
U3531	1/4"	7/8" ballcock	1.58"

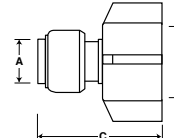

Faucet Connector Dimensions (Chrome Plated)

P/N	A	B	C
U3525	1/4"	1/2" NPS	1.58"

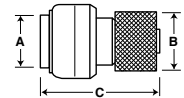

Stop Connector Dimensions (Chrome Plated)

P/N	A	B	C
U3523	1/4"	9/16" X 24 UNEF	1.61"

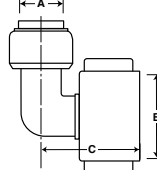

Ballcock Elbow Dimensions (Chrome Plated)

P/N	A	B	C
U3537	1/4"	7/8" ballcock	1.05"