

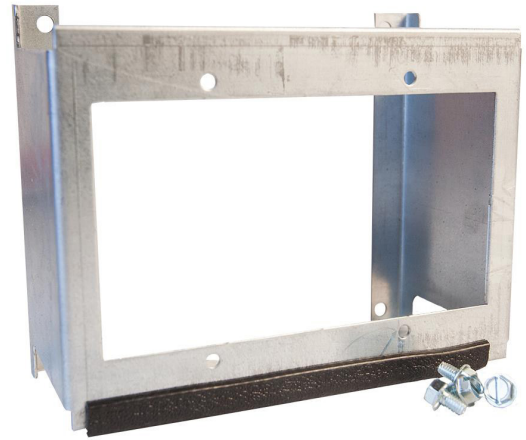

MILBANK
ENERGY AT WORK

K5400-BRIDGE-2POS



Catalog Number	K5400-BRIDGE-2POS
Marketing Product Description	Receptacle Mounting Bridge Millennium 2 Position
UPC	784572319264
Length (IN)	5.259
Width (IN)	2.938
Height (IN)	2.938
Weight (LB)	0.88
Brand Name	Milbank
Type	Product Support
Application	RV or Mobile Home Accessory
Standard	UL Listed
Cover Type	No Cover
Enclosure	No Enclosure
Material	G90 Galvanized Steel
Finish	Unpainted
Consist Of	Fitting
Knockouts	False
NEMA Rating	No Rating

Please consult serving utility for their requirements prior to ordering or installing, as specifications and approvals vary by utility and may require local electrical inspector approval. All installations must be installed by a licensed electrician and must comply with all national and local codes, laws and regulations. Milbank reserves the right to make changes in specifications and features shown without notice or obligation.

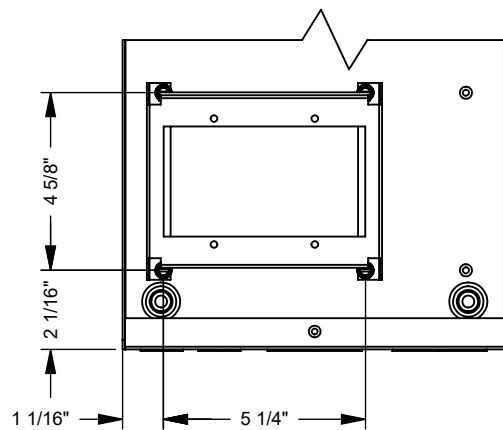
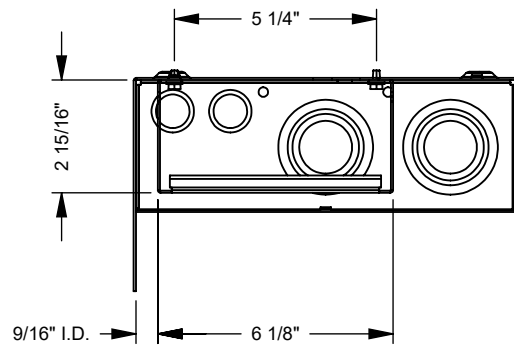

ENCLOSURE

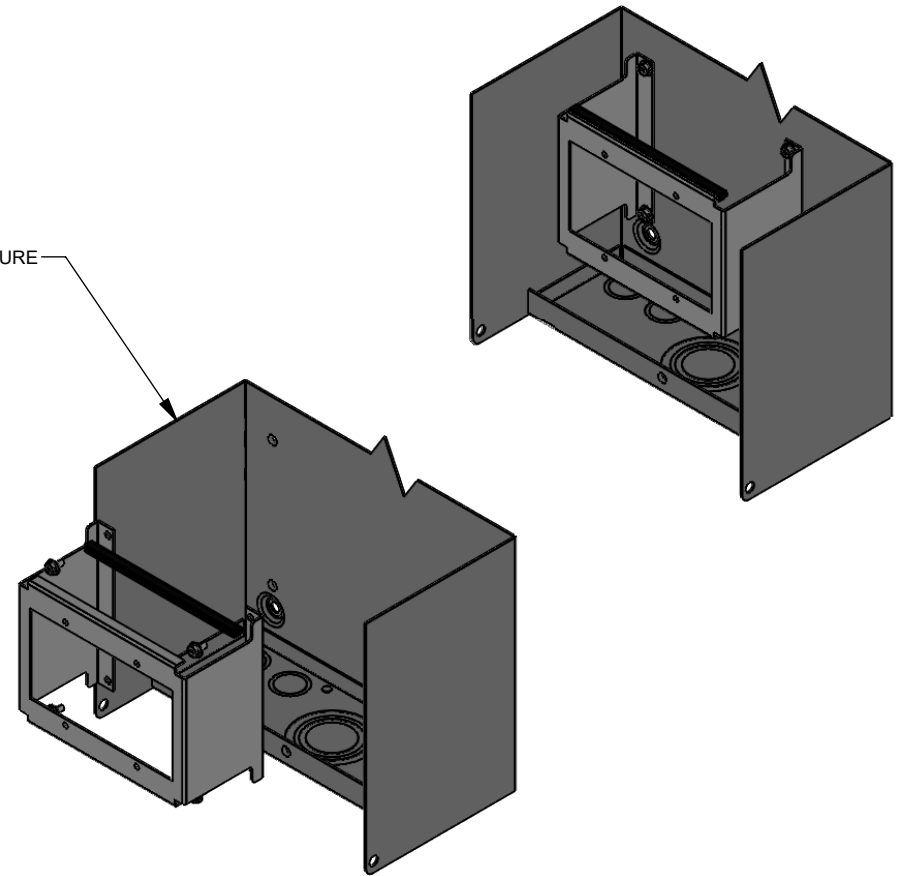

MILBANK
ENERGY AT WORK

Version:

1

**All dimensions are +/- 1/16".
Drawing views are not to scale.**

Please consult serving utility for their requirements prior to ordering or installing, as specifications and approvals vary by utility, and may require local electrical inspector approval. All installations must be installed by a licensed electrician and must comply with all national and local codes, laws and regulations. Milbank reserves the right to make changes in specifications and features shown without notice or obligation.